

# LOW MAINTENANCE MEADOW FACT SHEET

Throw your mower away and replace your lawn with these beautiful low maintenance indigenous plants.

The recommended plants in this design are selected for their toughness, adaptability and weed suppressing qualities.

The paired back plant palette creates a cohesive, tidy garden year-round with each plant creating its own seasonal interest through foliage and flower.

View from above.  
This will help you  
with planting

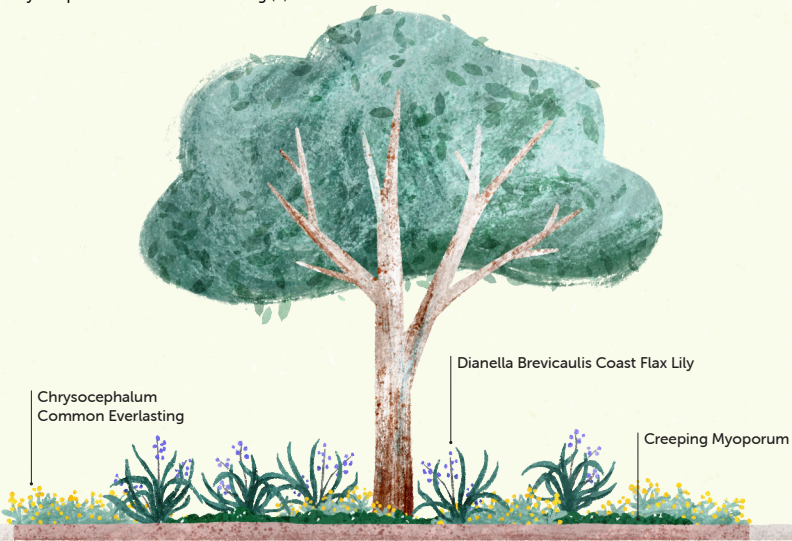
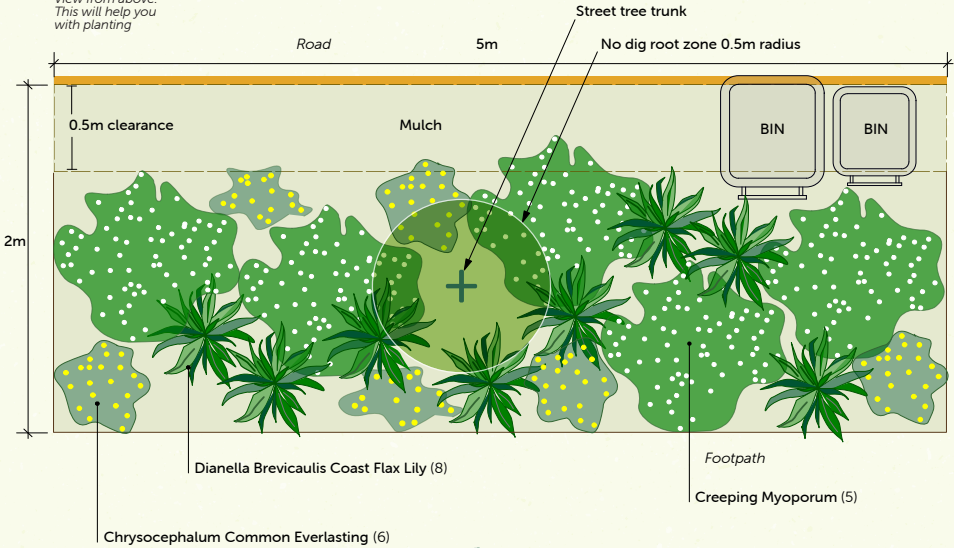

View from the street

Driveway crossover

# RECOMMENDED PLANTS

Based on average nature strip being five metres long by two metres wide, it is recommended to plant the following:

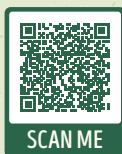

**Nature strip maintenance requirements:**  
As per Hobsons Bay City Council guidelines, residents are required to maintain the nature strip adjacent to their property. This involves keeping it free of trip hazards, protruding objects and ensuring pathways, gutters and driveways are free of weeds, rubbish, and mulch. **Scan to view the Nature Strip Landscape Guidelines**

## COAST FLAX LILY

8

*Dianella brevicaulis*

**Height:** 50cm

**Width:** 50cm

**Sun:** Full sun, semi shade

**Soil type:** Any, prefers well drained. Useful planted under Eucalyptus trees where little else will grow

**Flowers and seed:** Dark blue flowers Oct – Dec. Cobalt blue berries through summer

**Ecological role:** Bird attracting berries

**Maintenance:** Dianella do not need pruning for the first several years but will then benefit from a periodic prune. Prune to remove old flower spikes from the base of the plant once berries are finished in late autumn. Remove dead or yellowing leaves to keep plant looking tidy

## COMMON EVERLASTING

6

*Chrysocephalum apiculatum*

**Height:** 20cm

**Width:** 50cm

**Sun:** Full sun, semi shade

**Soil type:** Most soil types, prefers well drained soil  
**Flowers:** Bright gold flowers all year

**Ecological role:** Butterfly attracting

**Maintenance:** Prune late winter or early spring when the plant looks tired

## CREEPING MYOPORIUM

5

*Myoporium parvifolium*

**Height:** Prostrate

**Width:** 1-2m

**Sun:** Full sun, semi shade

**Soil type:** Prefers well drained soil, very adaptable. Hardy weed-suppressing groundcover tolerates light foot traffic

**Flowers:** Masses of white flowers Oct – Feb

**Ecological role:** Butterfly attracting, autumn fruit eaten by Rosellas

**Maintenance:** Prune late winter or early spring to prevent excessive growth and maintain a tidy appearance

## TOO HARD?

### Try our super minimalist design

Replace your lawn with a single indigenous species for a low maintenance alternative that provides enormous benefits to our local wildlife.

## LOMANDRA LONGIFOLIA

**Spacing:** four plants per m<sup>2</sup>

## MYOPORIUM PARVIFOLIUM

**Spacing:** two plants per m<sup>2</sup>

## KENNEDIA PROSTRATA

**Spacing:** two plants per m<sup>2</sup>



Contact email

habitatgardens@hobsonsbay.vic.gov.au

 Recommended number of plants to buy