

**SIGN SCHEDULE**

- |     |  |         |     |  |                  |     |  |           |
|-----|--|---------|-----|--|------------------|-----|--|-----------|
| #1  |  | R1-1    | #18 |  | R7-4             | #26 |  | W4-3      |
| #2  |  | R1-2    | #21 |  | W3-4 (MODIFIED)  | #27 |  |           |
| #4  |  | D4-1-2  | #22 |  | W5-10 (MODIFIED) | #28 |  | R4-10(40) |
| #13 |  | R2-2(L) | #23 |  | W8-2(30)         | #29 |  | R5-35(R)  |
| #17 |  | R7-1-4  | #25 |  | G9-58            |     |  |           |

PROVIDE 1.5m KERB OPENING EVERY 10m

FOR CONTINUATION SEE TRAFFIC CONTROL SHEET 2

**LEGEND**

- PROPOSED UNBROKEN PAINTED LINE 100mm WIDE
- PROPOSED LANE LINE 3m x 9m GAP 100mm WIDE
- PROPOSED CONTINUITY LINE 1m x 3m GAP 100mm WIDE
- PROPOSED STOP LINE 300mm WIDE THEN 0.6m x 0.6m GAP 150mm WIDE
- PROPOSED BICYCLE LANE LINE MARKING 1m x 3m GAP 75mm WIDE
- ELECTRICITY POLE - EXISTING
- PROPOSED SIGN - SINGLE POST
- PROPOSED TGSi - WARNING
- RAISED PLATFORM RAMP LINE MARKING
- DISTINCTIVE COLOURED PAVEMENT MARKING
- YELLOW COLOURED SURFACE TREATMENT

**WARNING**  
BEWARE OF UNDERGROUND SERVICES  
THE LOCATIONS OF UNDERGROUND SERVICES ARE APPROXIMATE ONLY AND THEIR EXACT POSITION SHOULD BE PROVEN ON SITE. NO GUARANTEE IS GIVEN THAT ALL EXISTING SERVICES ARE SHOWN.



| ISSUE | APP'D | DATE     | AMENDMENT DETAILS       |
|-------|-------|----------|-------------------------|
| 1     |       | 11/08/23 | ISSUED FOR CONSTRUCTION |
|       |       |          |                         |
|       |       |          |                         |

**HOBSONS BAY CITY COUNCIL**



|                 |                     |
|-----------------|---------------------|
| ISSUE           | CONSTRUCTION        |
| A.H.D./COORD    | GDA2020/MGA ZONE 55 |
| MELWAY REF. No. | 55K2                |
| DRAWING No.     | HB107-1             |
| PROJECT No.:    |                     |

|          |  |               |   |
|----------|--|---------------|---|
| DESIGN   | HBS/SB   | PROJECT NAME  | ROAD REHABILITATION / RECONSTRUCTION HALL ST (STAGE 1) BETWEEN HIGH ST & BURLEIGH ST, NEWPORT |
| DRAWN    | HBS/AP   | DRAWING TITLE | TRAFFIC CONTROL SHEET 1 - MC00 CH 0- CH 120   |
| CHECKED  | SB   | DRAWING SCALE | SCALE OF METRES<br>HOR 0 3 6  |
| APPROVED | AK   | VER           | SHEET No.: 18 OF 24   |
| CAD REF  | J:\CAPITALWORKS\HALL STREET PROJECT\CAD FILE\CAD FILE\HB107-1 - STANDARD\HB107-2 |               | REVISION 1  |
| PDF REF  |  |               | PAPER SIZE <b>A3</b>  |

**SIGN SCHEDULE**

- |     |  |         |     |  |                  |     |  |           |
|-----|--|---------|-----|--|------------------|-----|--|-----------|
| #1  |  | R1-1    | #18 |  | R7-4             | #26 |  | W4-3      |
| #2  |  | R1-2    | #21 |  | W3-4 (MODIFIED)  | #27 |  |           |
| #4  |  | D4-1-2  | #22 |  | W5-10 (MODIFIED) | #28 |  | R4-10(40) |
| #13 |  | R2-2(L) | #23 |  | W8-2(30)         | #29 |  | R5-35(R)  |
| #17 |  | R7-1-4  | #25 |  | G9-58            |     |  |           |

PROVIDE 1.5m KERB OPENING EVERY 10m

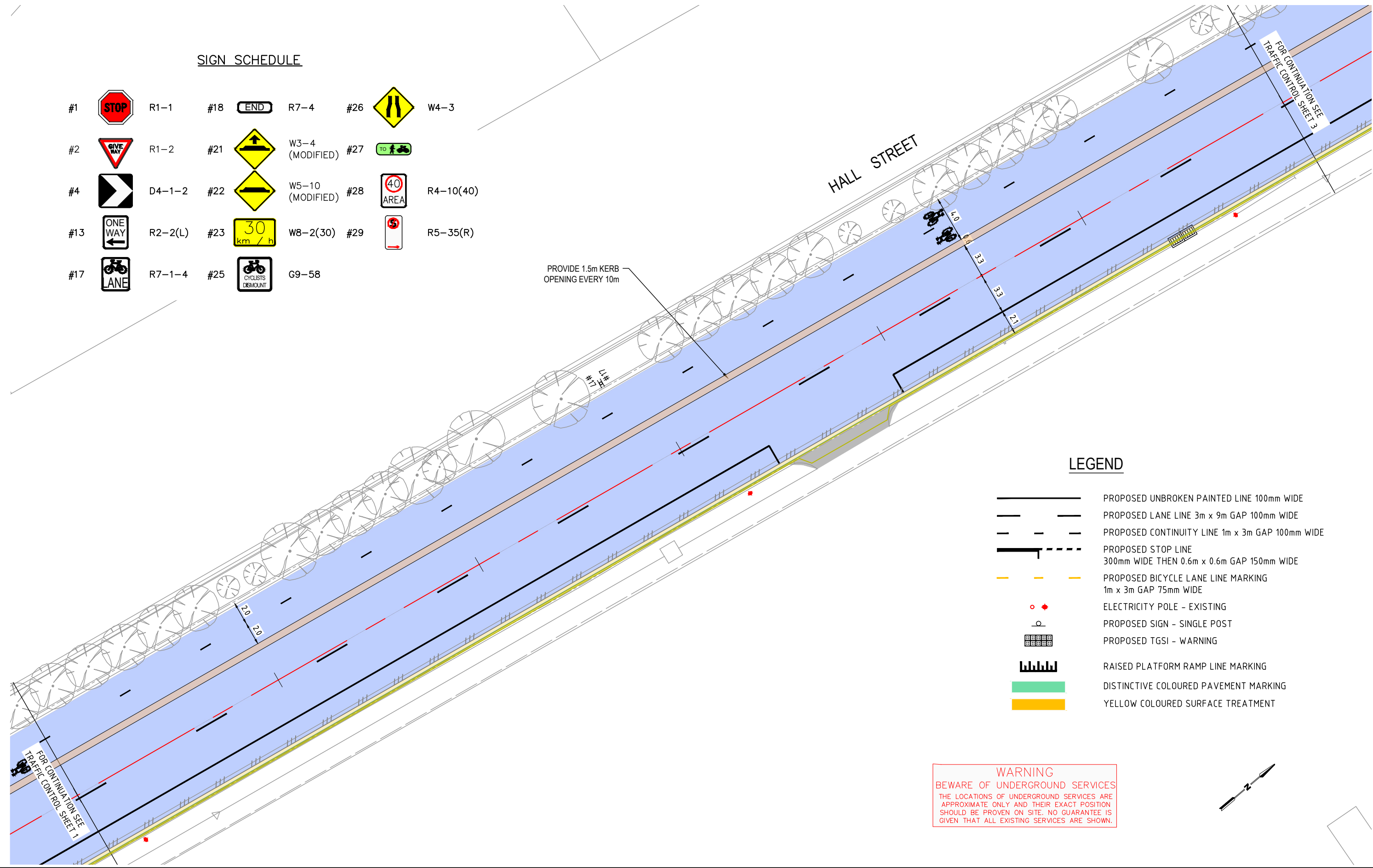

**LEGEND**

- PROPOSED UNBROKEN PAINTED LINE 100mm WIDE
- PROPOSED LANE LINE 3m x 9m GAP 100mm WIDE
- PROPOSED CONTINUITY LINE 1m x 3m GAP 100mm WIDE
- PROPOSED STOP LINE 300mm WIDE THEN 0.6m x 0.6m GAP 150mm WIDE
- PROPOSED BICYCLE LANE LINE MARKING 1m x 3m GAP 75mm WIDE
- ELECTRICITY POLE - EXISTING
- PROPOSED SIGN - SINGLE POST
- PROPOSED TGS1 - WARNING
- RAISED PLATFORM RAMP LINE MARKING
- DISTINCTIVE COLOURED PAVEMENT MARKING
- YELLOW COLOURED SURFACE TREATMENT

**WARNING**  
BEWARE OF UNDERGROUND SERVICES  
THE LOCATIONS OF UNDERGROUND SERVICES ARE APPROXIMATE ONLY AND THEIR EXACT POSITION SHOULD BE PROVEN ON SITE. NO GUARANTEE IS GIVEN THAT ALL EXISTING SERVICES ARE SHOWN.



| ISSUE | APP'D | DATE     | AMENDMENT DETAILS       |
|-------|-------|----------|-------------------------|
| 1     |       | 11/08/23 | ISSUED FOR CONSTRUCTION |
|       |       |          |                         |
|       |       |          |                         |

**HOBSONS BAY CITY COUNCIL**



| ISSUE           | CONSTRUCTION        |
|-----------------|---------------------|
| A.H.D./COORD    | GDA2020/MGA ZONE 55 |
| MELWAY REF. No: | 55K2                |
| DRAWING No:     | HB107-1             |
| PROJECT No.:    |                     |

| DESIGN   | HBS/SB   | PROJECT NAME  | ROAD REHABILITATION / RECONSTRUCTION HALL ST ( STAGE 1) BETWEEN HIGH ST & BURLEIGH ST, NEWPORT |
|----------|--|---------------|--|
| DRAWN    | HBS/AP   | DRAWING TITLE | TRAFFIC CONTROL SHEET 2 -MC00 CH 120- CH 240   |
| CHECKED  | SB   | DRAWING SCALE | SCALE OF METRES<br>HOR 0 3 6   |
| APPROVED | AK   | VER           | SHEET No.: 19 OF 24  |
| CAD REF  | J:\CAPITALWORKS\HALL STREET PROJECT\CAD FILE\CAD FILE\HB107-1 - STANDARD\HB107-2 |               | REVISION 1   |
| PDF REF  |  |               | PAPER SIZE <b>A3</b>   |

**SIGN SCHEDULE**

- |     |  |         |     |  |                  |     |  |           |
|-----|--|---------|-----|--|------------------|-----|--|-----------|
| #1  |  | R1-1    | #18 |  | R7-4             | #26 |  | W4-3      |
| #2  |  | R1-2    | #21 |  | W3-4 (MODIFIED)  | #27 |  |           |
| #4  |  | D4-1-2  | #22 |  | W5-10 (MODIFIED) | #28 |  | R4-10(40) |
| #13 |  | R2-2(L) | #23 |  | W8-2(30)         | #29 |  | R5-35(R)  |
| #17 |  | R7-1-4  | #25 |  | G9-58            |     |  |           |

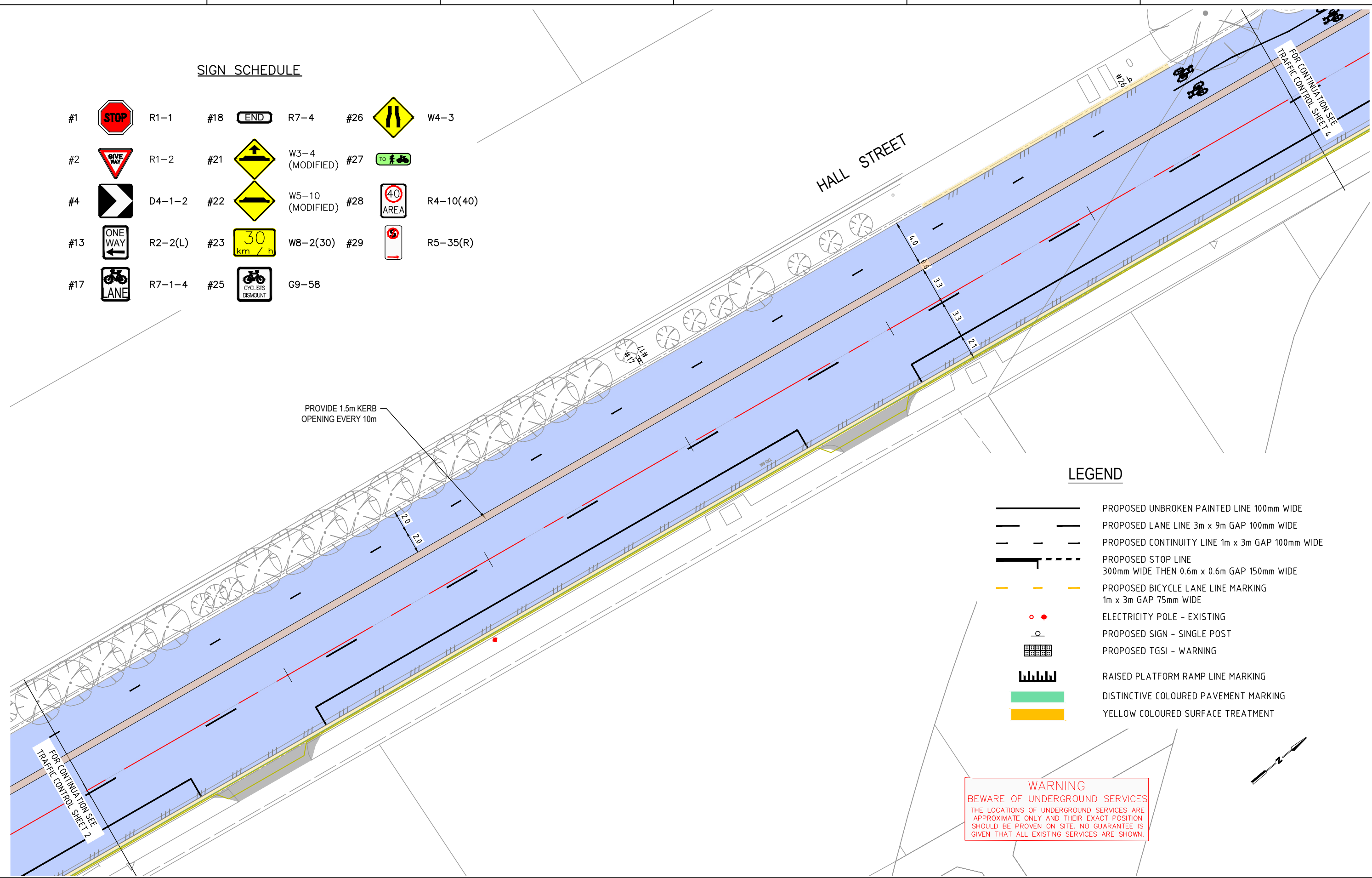

**LEGEND**

- PROPOSED UNBROKEN PAINTED LINE 100mm WIDE
- PROPOSED LANE LINE 3m x 9m GAP 100mm WIDE
- PROPOSED CONTINUITY LINE 1m x 3m GAP 100mm WIDE
- PROPOSED STOP LINE 300mm WIDE THEN 0.6m x 0.6m GAP 150mm WIDE
- PROPOSED BICYCLE LANE LINE MARKING 1m x 3m GAP 75mm WIDE
- ELECTRICITY POLE - EXISTING
- PROPOSED SIGN - SINGLE POST
- PROPOSED TGS1 - WARNING
- RAISED PLATFORM RAMP LINE MARKING
- DISTINCTIVE COLOURED PAVEMENT MARKING
- YELLOW COLOURED SURFACE TREATMENT

**WARNING**  
 BEWARE OF UNDERGROUND SERVICES  
 THE LOCATIONS OF UNDERGROUND SERVICES ARE APPROXIMATE ONLY AND THEIR EXACT POSITION SHOULD BE PROVEN ON SITE. NO GUARANTEE IS GIVEN THAT ALL EXISTING SERVICES ARE SHOWN.



| ISSUE | APP'D | DATE     | AMENDMENT DETAILS       |
|-------|-------|----------|-------------------------|
| 1     |       | 11/08/23 | ISSUED FOR CONSTRUCTION |
|       |       |          |                         |
|       |       |          |                         |



| ISSUE           | CONSTRUCTION        |
|-----------------|---------------------|
| A.H.D./COORD    | GDA2020/MGA ZONE 55 |
| MELWAY REF. No. | 55K2                |
| DRAWING No.     | HB107-1             |
| PROJECT No.:    |                     |

| DESIGN   | HBS /SB  | PROJECT NAME  | ROAD REHABILITATION / RECONSTRUCTION HALL ST ( STAGE 1) BETWEEN HIGH ST & BURLEIGH ST, NEWPORT |
|----------|--|---------------|--|
| DRAWN    | HBS/ AP  | DRAWING TITLE | TRAFFIC CONTROL SHEET 3 - MC00 CH 240- CH 360  |
| CHECKED  | SB   | DRAWING SCALE | SCALE OF METRES<br>HOR 0 3 6   |
| APPROVED | AK   | VER           | SHEET No.: 20 OF 24  |
| CAD REF  | J:\CAPITALWORKS\HALL STREET PROJECT\CAD FILE\CAD FILE\HB107-1 - STANDARD\HB107-2 |               | REVISION 1   |
| PDF REF  |  |               | PAPER SIZE <b>A3</b>   |

**SIGN SCHEDULE**

- |     |  |         |     |  |                  |     |  |           |
|-----|--|---------|-----|--|------------------|-----|--|-----------|
| #1  |  | R1-1    | #18 |  | R7-4             | #26 |  | W4-3      |
| #2  |  | R1-2    | #21 |  | W3-4 (MODIFIED)  | #27 |  |           |
| #4  |  | D4-1-2  | #22 |  | W5-10 (MODIFIED) | #28 |  | R4-10(40) |
| #13 |  | R2-2(L) | #23 |  | W8-2(30)         | #29 |  | R5-35(R)  |
| #17 |  | R7-1-4  | #25 |  | G9-58            |     |  |           |

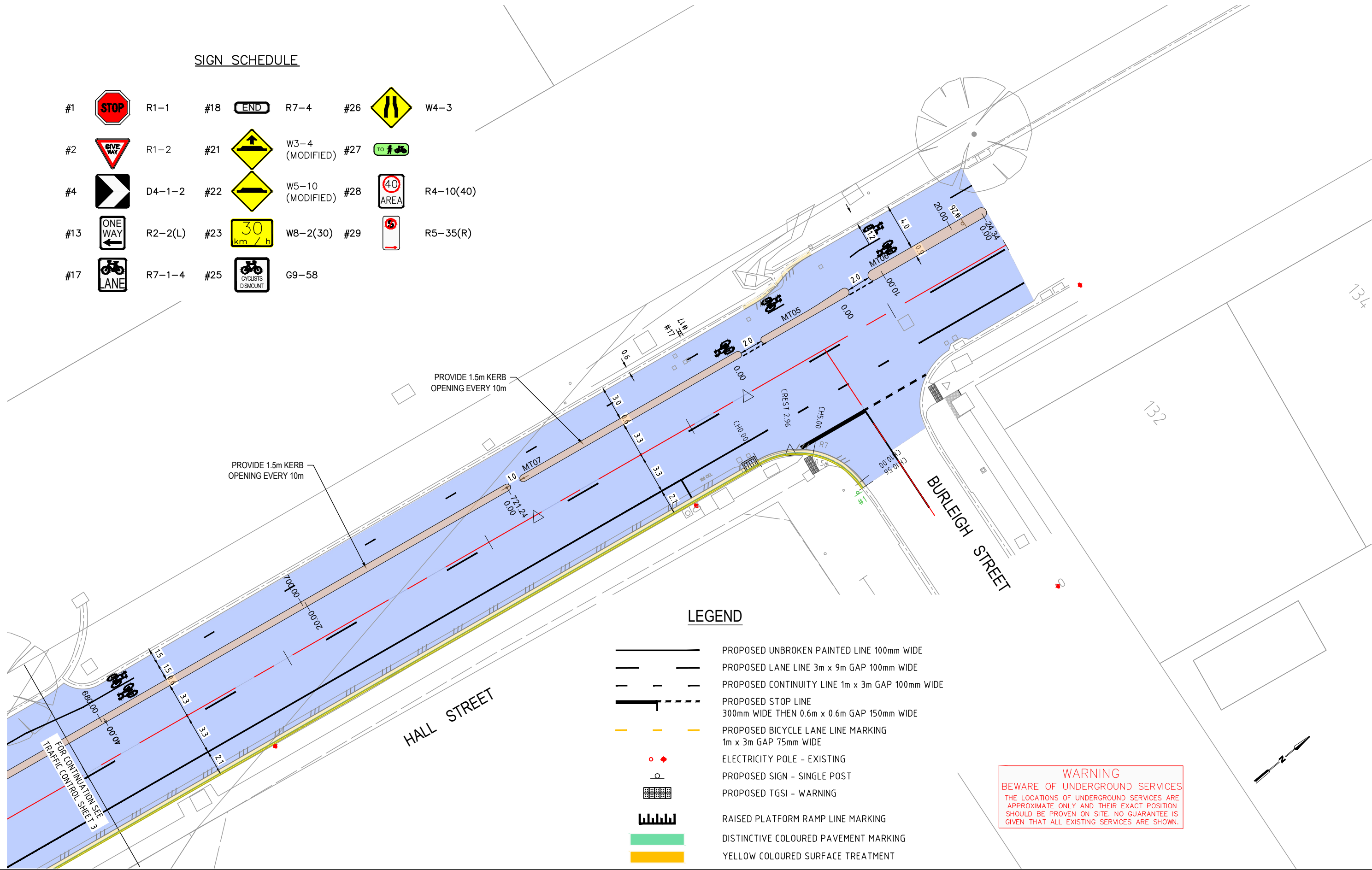

**LEGEND**

- PROPOSED UNBROKEN PAINTED LINE 100mm WIDE
- PROPOSED LANE LINE 3m x 9m GAP 100mm WIDE
- PROPOSED CONTINUITY LINE 1m x 3m GAP 100mm WIDE
- PROPOSED STOP LINE  
300mm WIDE THEN 0.6m x 0.6m GAP 150mm WIDE
- PROPOSED BICYCLE LANE LINE MARKING  
1m x 3m GAP 75mm WIDE
- ELECTRICITY POLE - EXISTING
- PROPOSED SIGN - SINGLE POST
- PROPOSED TGS - WARNING
- RAISED PLATFORM RAMP LINE MARKING
- DISTINCTIVE COLOURED PAVEMENT MARKING
- YELLOW COLOURED SURFACE TREATMENT

**WARNING**  
BEWARE OF UNDERGROUND SERVICES  
THE LOCATIONS OF UNDERGROUND SERVICES ARE APPROXIMATE ONLY AND THEIR EXACT POSITION SHOULD BE PROVEN ON SITE. NO GUARANTEE IS GIVEN THAT ALL EXISTING SERVICES ARE SHOWN.



| ISSUE | APP'D | DATE     | AMENDMENT DETAILS       |
|-------|-------|----------|-------------------------|
| 1     |       | 11/08/23 | ISSUED FOR CONSTRUCTION |
|       |       |          |                         |
|       |       |          |                         |
|       |       |          |                         |



| ISSUE           | CONSTRUCTION        |
|-----------------|---------------------|
| A.H.D./COORD    | GDA2020/MGA ZONE 55 |
| MELWAY REF. No: | 55K2                |
| DRAWING No:     | HB107-1             |
| PROJECT No.:    |                     |

| DESIGN   | HBS /SB  | PROJECT NAME  | ROAD REHABILITATION / RECONSTRUCTION<br>HALL ST ( STAGE 1) BETWEEN HIGH ST & BURLEIGH ST, NEWPORT |
|----------|--|---------------|---|
| DRAWN    | HBS/ AP  | DRAWING TITLE | TRAFFIC CONTROL SHEET 4 -MC00 CH 360- CH 451.32   |
| CHECKED  | SB   | DRAWING SCALE | SCALE OF METRES<br>HOR 0 3 6<br>VER   |
| APPROVED | AK   |               | SHEET No.:<br>21 OF 24  |
| CAD REF  | J:\CAPITALWORKS\HALL STREET PROJECT\CAD FILE\CAD FILE\HB107-1 - STANDARD\HB107-2 |               | REVISION<br>1   |
| PDF REF  |  |               | PAPER SIZE<br>A3  |

**SIGN SCHEDULE**

|    |  |        |     |  |          |
|----|--|--------|-----|--|----------|
| #1 |  | R1-1   | #17 |  | R7-1-4   |
| #9 |  | D4-2-1 | #18 |  | R7-4     |
|    |  |        | #19 |  | G9-63(R) |

HALL STREET

PROVIDE 1.5m KERB OPENING EVERY 10m

**LEGEND**

|  |   |
|--|---|
|  | PROPOSED UNBROKEN PAINTED LINE 100mm WIDE                     |
|  | PROPOSED LANE LINE 3m x 9m GAP 100mm WIDE                     |
|  | PROPOSED CONTINUITY LINE 1m x 3m GAP 100mm WIDE               |
|  | PROPOSED HOLDING LINE FOR CYCLIST 0.6m x 0.6m GAP 150mm WIDE  |
|  | PROPOSED STOP LINE 300mm WIDE THEN 0.6m x 0.6m GAP 150mm WIDE |
|  | PROPOSED BICYCLE LANE LINE MARKING 1m x 3m GAP 75mm WIDE      |
|  | PROPOSED BICYCLE LANE LINE MARKING 0.6m x 0.6m GAP 75mm WIDE  |
|  | PROPOSED BICYCLE LANE LINE MARKING 75mm WIDE                  |
|  | PROPOSED REFLECTIVE YELLOW LINE 100mm WIDE                    |
|  | ELECTRICITY POLE - EXISTING                                   |
|  | PROPOSED SIGN - SINGLE POST                                   |
|  | PROPOSED TGSi - WARNING                                       |
|  | DISTINCTIVE COLOURED PAVEMENT MARKING                         |
|  | RAISED REFLECTIVE PAVEMENT MARKER                             |

**WARNING**  
BEWARE OF UNDERGROUND SERVICES  
THE LOCATIONS OF UNDERGROUND SERVICES ARE APPROXIMATE ONLY AND THEIR EXACT POSITION SHOULD BE PROVEN ON SITE. NO GUARANTEE IS GIVEN THAT ALL EXISTING SERVICES ARE SHOWN.

**DETAILED DESIGN**

|       |       |            |   |
|-------|-------|------------|---|
| ISSUE | APP'D | DATE       | AMENDMENT                                   |
| A     |       | 30/05/2022 | UPDATE TRAFFIC ISLANDS, DETAILS AND NOTES   |
| B     |       | 23/06/2022 | UPDATE TRAFFIC CONTROL LINE MARKING & RRPMS |

**GENERAL NOTES**

1. BASE INFORMATION FROM PETER RICHARDS SURVEYING 17654.DWG.
2. VERTICAL LEVELS ARE AUSTRALIAN HEIGHT DATUM (AHD) DERIVED FROM PERMANENT SURVEY MARK CUT PAW PAW PM 332 RL.15.750 & CUT PAW PAW PM 520 RL. 9.40.
3. COORDINATES ARE MGA2020 ZONE 55.
4. LOCAL ROAD - HALL STREET & ALL OTHER SIDE STREETS, SPEED ZONE - 50KM/H.

**hds**  
Waverley Business Centre  
21-23 Aristoc Road  
Glen Waverley VIC 3150  
Telephone: 03 9550 1858  
vic@hdsaustralia.com.au

DESIGNED: HZ  
APPROVED: DA

CAT: [ ]  
PROJ: [ ]  
FILE: [ ]

**Hobsons Bay**  
CITY COUNCIL

SCALE OF METRES  
HOR 0 3 6  
VER [ ]

|  |              |           |             |       |
|--|--------------|-----------|-------------|-------|
| ROAD REHABILITATION / RECONSTRUCTION<br>HALL STREET (STAGE 2) BETWEEN BURLEIGH STREET<br>AND CRAIG STREET, SPOTSWOOD<br>TRAFFIC CONTROL SHEET 1 - MC10 CH 0 - CH 120 |              |           |             |       |
| FILE NO.   | CONTRACT NO. | SHEET NO. | DRAWING NO. | ISSUE |
|  |              | 11 OF 17  | HB107-2     | B     |

\$MODEL NAMES  
\$FILES  
\$DATES  
\$TIMES

**SIGN SCHEDULE**

|    |  |        |     |  |          |
|----|--|--------|-----|--|----------|
| #1 |  | R1-1   | #17 |  | R7-1-4   |
| #9 |  | D4-2-1 | #18 |  | R7-4     |
|    |  |        | #19 |  | G9-63(R) |

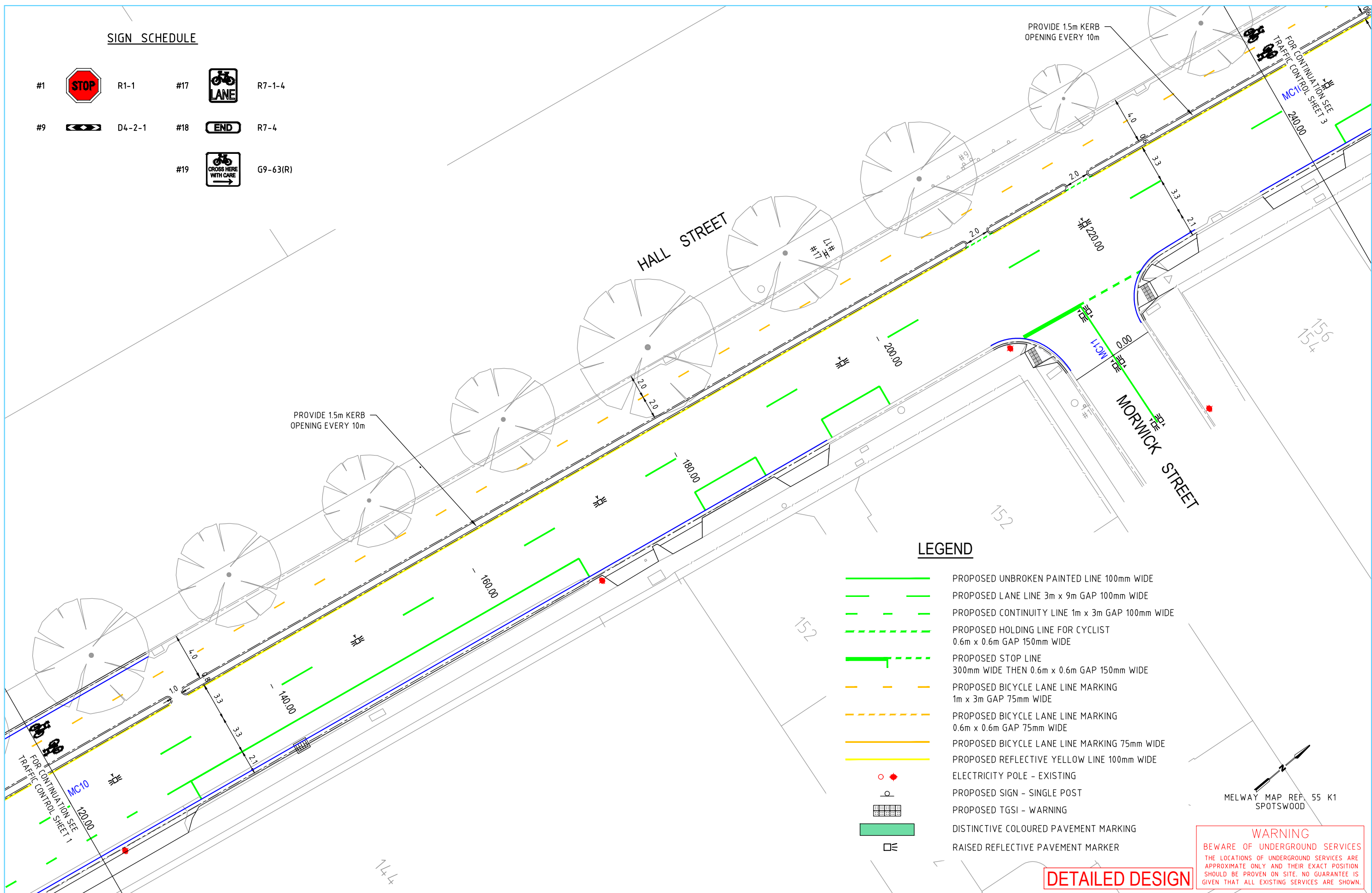

**LEGEND**

|  |   |
|--|---|
|  | PROPOSED UNBROKEN PAINTED LINE 100mm WIDE                     |
|  | PROPOSED LANE LINE 3m x 9m GAP 100mm WIDE                     |
|  | PROPOSED CONTINUITY LINE 1m x 3m GAP 100mm WIDE               |
|  | PROPOSED HOLDING LINE FOR CYCLIST 0.6m x 0.6m GAP 150mm WIDE  |
|  | PROPOSED STOP LINE 300mm WIDE THEN 0.6m x 0.6m GAP 150mm WIDE |
|  | PROPOSED BICYCLE LANE LINE MARKING 1m x 3m GAP 75mm WIDE      |
|  | PROPOSED BICYCLE LANE LINE MARKING 0.6m x 0.6m GAP 75mm WIDE  |
|  | PROPOSED BICYCLE LANE LINE MARKING 75mm WIDE                  |
|  | PROPOSED REFLECTIVE YELLOW LINE 100mm WIDE                    |
|  | ELECTRICITY POLE - EXISTING                                   |
|  | PROPOSED SIGN - SINGLE POST                                   |
|  | PROPOSED TGS - WARNING  |
|  | DISTINCTIVE COLOURED PAVEMENT MARKING                         |
|  | RAISED REFLECTIVE PAVEMENT MARKER                             |

MELWAY MAP REF. 55 K1 SPOTSWOOD

**WARNING**  
BEWARE OF UNDERGROUND SERVICES  
THE LOCATIONS OF UNDERGROUND SERVICES ARE APPROXIMATE ONLY AND THEIR EXACT POSITION SHOULD BE PROVEN ON SITE. NO GUARANTEE IS GIVEN THAT ALL EXISTING SERVICES ARE SHOWN.

**DETAILED DESIGN**

|       |       |            |   |
|-------|-------|------------|---|
| ISSUE | APP'D | DATE       | AMENDMENT                                   |
| A     |       | 30/05/2022 | UPDATE TRAFFIC ISLANDS, DETAILS AND NOTES   |
| B     |       | 23/06/2022 | UPDATE TRAFFIC CONTROL LINE MARKING & RRPMS |

**GENERAL NOTES**

1. BASE INFORMATION FROM PETER RICHARDS SURVEYING 17654.DWG.
2. VERTICAL LEVELS ARE AUSTRALIAN HEIGHT DATUM (AHD) DERIVED FROM PERMANENT SURVEY MARK CUT PAW PAW PM 332 RL.15.750 & CUT PAW PAW PM 520 RL. 9.40.
3. COORDINATES ARE MGA2020 ZONE 55.
4. LOCAL ROAD - HALL STREET & ALL OTHER SIDE STREETS, SPEED ZONE - 50KM/H.

**hds**  
Waverley Business Centre  
21-23 Aristoc Road  
Glen Waverley VIC 3150  
Telephone: 03 9550 1858  
vic@hdsaustralia.com.au

DESIGNED: HZ  
APPROVED: DA





CAT: \_\_\_\_\_  
PROJ: \_\_\_\_\_  
FILE: \_\_\_\_\_

**Hobsons Bay**  
CITY COUNCIL

SCALE OF METRES  
HOR 0 3 6  
VER \_\_\_\_\_







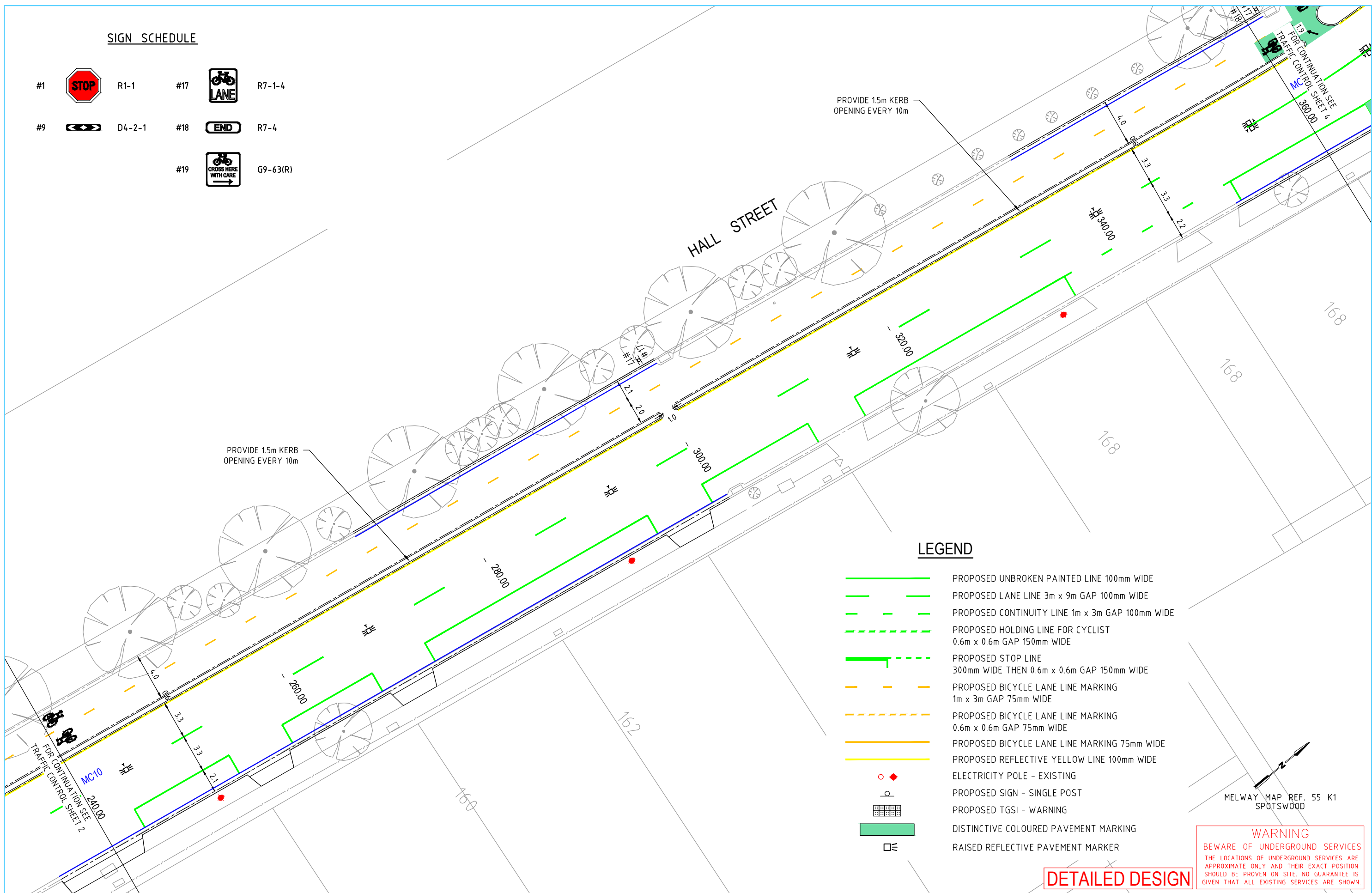







|   |              |           |             |       |
|---|--------------|-----------|-------------|-------|
| ROAD REHABILITATION / RECONSTRUCTION<br>HALL STREET (STAGE 2) BETWEEN BURLEIGH STREET AND CRAIG STREET, SPOTSWOOD<br>TRAFFIC CONTROL SHEET 2 - MC10 CH 120 - CH 240 |              |           |             |       |
| FILE NO.  | CONTRACT NO. | SHEET NO. | DRAWING NO. | ISSUE |
|   |              | 12 OF 17  | HB107-2     | B     |

**SIGN SCHEDULE**

- #1  R1-1
- #9  D4-2-1
- #17  R7-1-4
- #18  R7-4
- #19  G9-63(R)



**LEGEND**

-  PROPOSED UNBROKEN PAINTED LINE 100mm WIDE
-  PROPOSED LANE LINE 3m x 9m GAP 100mm WIDE
-  PROPOSED CONTINUITY LINE 1m x 3m GAP 100mm WIDE
-  PROPOSED HOLDING LINE FOR CYCLIST 0.6m x 0.6m GAP 150mm WIDE
-  PROPOSED STOP LINE 300mm WIDE THEN 0.6m x 0.6m GAP 150mm WIDE
-  PROPOSED BICYCLE LANE LINE MARKING 1m x 3m GAP 75mm WIDE
-  PROPOSED BICYCLE LANE LINE MARKING 0.6m x 0.6m GAP 75mm WIDE
-  PROPOSED BICYCLE LANE LINE MARKING 75mm WIDE
-  PROPOSED REFLECTIVE YELLOW LINE 100mm WIDE
-  ELECTRICITY POLE - EXISTING
-  PROPOSED SIGN - SINGLE POST
-  PROPOSED TGSi - WARNING
-  DISTINCTIVE COLOURED PAVEMENT MARKING
-  RAISED REFLECTIVE PAVEMENT MARKER

**WARNING**  
 BEWARE OF UNDERGROUND SERVICES  
 THE LOCATIONS OF UNDERGROUND SERVICES ARE APPROXIMATE ONLY AND THEIR EXACT POSITION SHOULD BE PROVEN ON SITE. NO GUARANTEE IS GIVEN THAT ALL EXISTING SERVICES ARE SHOWN.

**DETAILED DESIGN**

| SDATES | \$MODEL | APP'D | DATE       | AMENDMENT                                   |
|--------|---------|-------|------------|---|
| E      | D       | C     | B          | A   |
|        |         |       | 23/06/2022 | UPDATE TRAFFIC CONTROL LINE MARKING & RRPMS |
|        |         |       | 30/05/2022 | UPDATE TRAFFIC ISLANDS, DETAILS AND NOTES   |

**GENERAL NOTES**

1. BASE INFORMATION FROM PETER RICHARDS SURVEYING 17654.DWG.
2. VERTICAL LEVELS ARE AUSTRALIAN HEIGHT DATUM (AHD) DERIVED FROM PERMANENT SURVEY MARK CUT PAW PAW PM 332 RL.15.750 & CUT PAW PAW PM 520 RL. 9.40.
3. COORDINATES ARE MGA2020 ZONE 55.
4. LOCAL ROAD - HALL STREET & ALL OTHER SIDE STREETS, SPEED ZONE - 50KM/H.



DESIGNED: HZ

APPROVED: DA

Waverley Business Centre  
21-23 Aristoc Road  
Glen Waverley VIC 3150  
Telephone: 03 9550 1858  
vic@hdsaustralia.com.au







SCALE OF METRES

HOR 0 3 6

VER

| ROAD REHABILITATION / RECONSTRUCTION<br>HALL STREET (STAGE 2) BETWEEN BURLEIGH STREET<br>AND CRAIG STREET, SPOTSWOOD<br>TRAFFIC CONTROL SHEET 3 - MC10 CH 240 - CH 360 |              |           |             |       |
|--|--------------|-----------|-------------|-------|
| FILE NO.   | CONTRACT NO. | SHEET NO. | DRAWING NO. | ISSUE |
|  |              | 13 OF 17  | HB107-2     | B     |





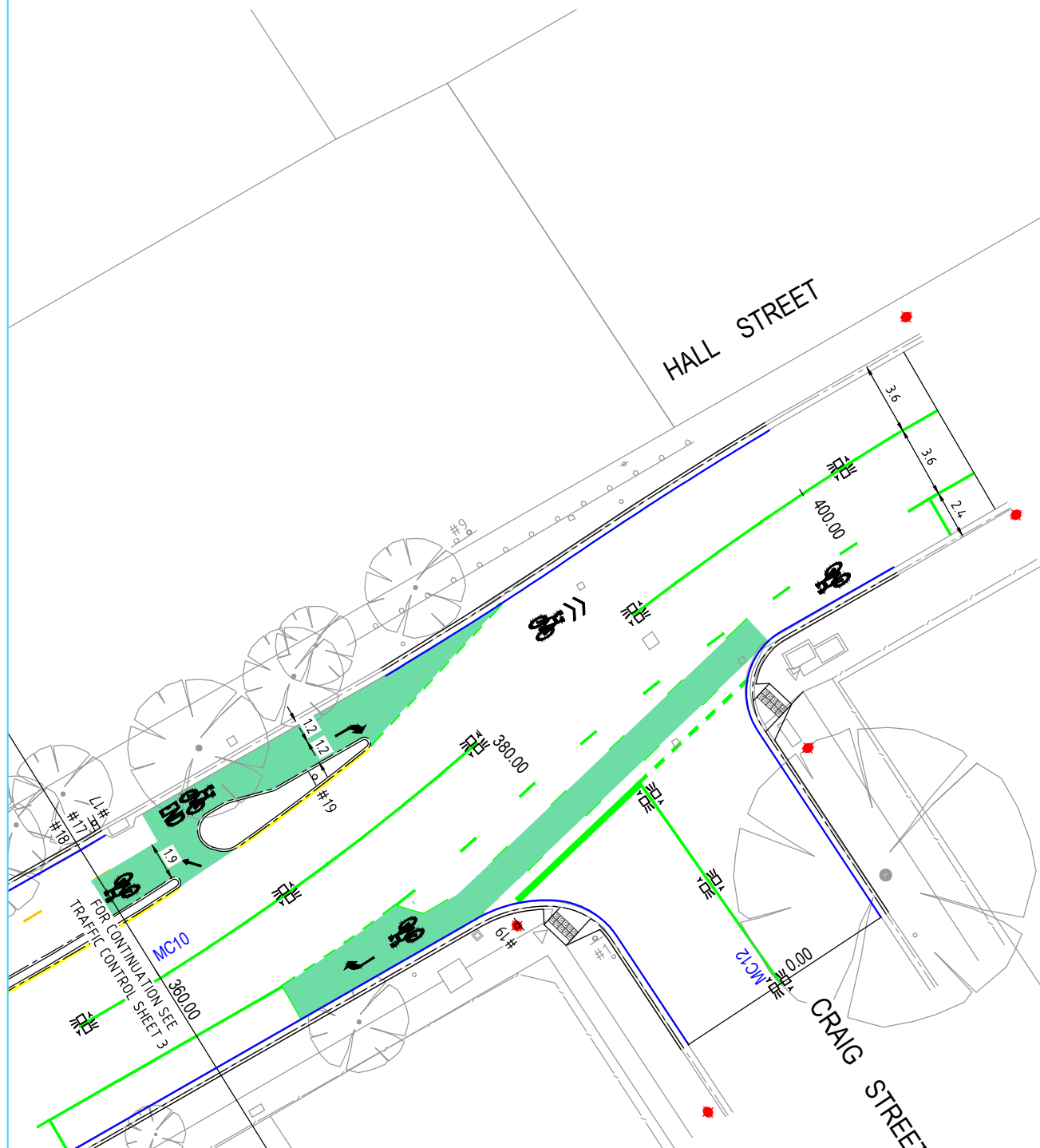









**SIGN SCHEDULE**

- #1  R1-1
- #9  D4-2-1
- #17  R7-1-4
- #18  R7-4
- #19  G9-63(R)

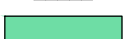

176

**LEGEND**

-  PROPOSED UNBROKEN PAINTED LINE 100mm WIDE
-  PROPOSED LANE LINE 3m x 9m GAP 100mm WIDE
-  PROPOSED CONTINUITY LINE 1m x 3m GAP 100mm WIDE
-  PROPOSED HOLDING LINE FOR CYCLIST 0.6m x 0.6m GAP 150mm WIDE
-  PROPOSED STOP LINE 300mm WIDE THEN 0.6m x 0.6m GAP 150mm WIDE
-  PROPOSED BICYCLE LANE LINE MARKING 1m x 3m GAP 75mm WIDE
-  PROPOSED BICYCLE LANE LINE MARKING 0.6m x 0.6m GAP 75mm WIDE
-  PROPOSED BICYCLE LANE LINE MARKING 75mm WIDE
-  PROPOSED REFLECTIVE YELLOW LINE 100mm WIDE
-  ELECTRICITY POLE - EXISTING
-  PROPOSED SIGN - SINGLE POST
-  PROPOSED TGSi - WARNING
-  DISTINCTIVE COLOURED PAVEMENT MARKING
-  RAISED REFLECTIVE PAVEMENT MARKER



MELWAY MAP REF. 55 K1 SPOTSWOOD

**WARNING**  
BEWARE OF UNDERGROUND SERVICES  
THE LOCATIONS OF UNDERGROUND SERVICES ARE APPROXIMATE ONLY AND THEIR EXACT POSITION SHOULD BE PROVEN ON SITE. NO GUARANTEE IS GIVEN THAT ALL EXISTING SERVICES ARE SHOWN.

**DETAILED DESIGN**

| DATE\$ | TIME\$     | MODEL NAME\$                                | SHEET\$   |
|--------|------------|---|-----------|
| E      |            |   |           |
| D      |            |   |           |
| C      |            |   |           |
| B      | 23/06/2022 | UPDATE TRAFFIC CONTROL LINE MARKING & RRPMS |           |
| A      | 30/05/2022 | UPDATE TRAFFIC ISLANDS, DETAILS AND NOTES   |           |
| ISSUE  | APP'D      | DATE  | AMENDMENT |

- GENERAL NOTES**
1. BASE INFORMATION FROM PETER RICHARDS SURVEYING 17654.DWG.
  2. VERTICAL LEVELS ARE AUSTRALIAN HEIGHT DATUM (AHD) DERIVED FROM PERMANENT SURVEY MARK CUT PAW PAW PM 332 RL.15.750 & CUT PAW PAW PM 520 RL. 9.40.
  3. COORDINATES ARE MGA2020 ZONE 55.
  4. LOCAL ROAD - HALL STREET & ALL OTHER SIDE STREETS, SPEED ZONE - 50KM/H.



Waverley Business Centre  
21-23 Aristoc Road  
Glen Waverley VIC 3150  
Telephone: 03 9550 1858  
vic@hdsaustralia.com.au

DESIGNED: HZ

APPROVED: DA

CAT: \_\_\_\_\_

PROJ: \_\_\_\_\_

FILE: \_\_\_\_\_



SCALE OF METRES

HOR 0 3 6

VER \_\_\_\_\_

|  |              |           |             |       |
|--|--------------|-----------|-------------|-------|
| <b>ROAD REHABILITATION / RECONSTRUCTION</b>                                      |              |           |             |       |
| <b>HALL STREET (STAGE 2) BETWEEN BURLEIGH STREET AND CRAIG STREET, SPOTSWOOD</b> |              |           |             |       |
| <b>TRAFFIC CONTROL SHEET 4 - MC10 CH 360 - CH 407.90</b>                         |              |           |             |       |
| FILE NO.   | CONTRACT NO. | SHEET NO. | DRAWING NO. | ISSUE |
|  |              | 14 OF 17  | HB107-2     | B     |